

SURVEYING

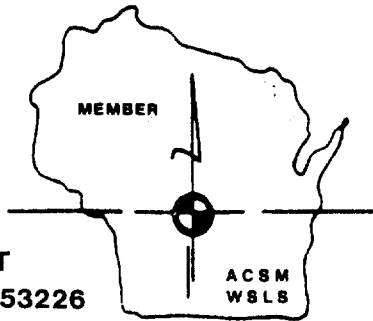

ASSOCIATES, INC.

2554 N. 100th STREET
WAUWATOSA, WISCONSIN 53226

FREDERICK W. SHIBILSKI RLS
(414) 257-2212

PLAT OF SURVEY
-of-

LOT 65, TROYJENS SUBDIVISION, located in the Southwest 1/4 of Section 19, Town 4 North, Range 18 East, in the Village of East Troy, County of Walworth, State of Wisconsin.

Survey location: 2028 Lilly Street

Buyer: Mark A. and Carol A. McShane

LILLY

ST.

66'

WIDE

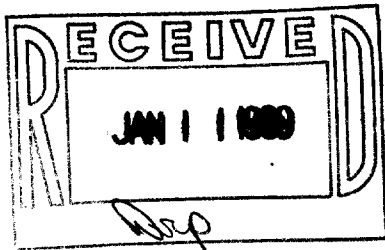
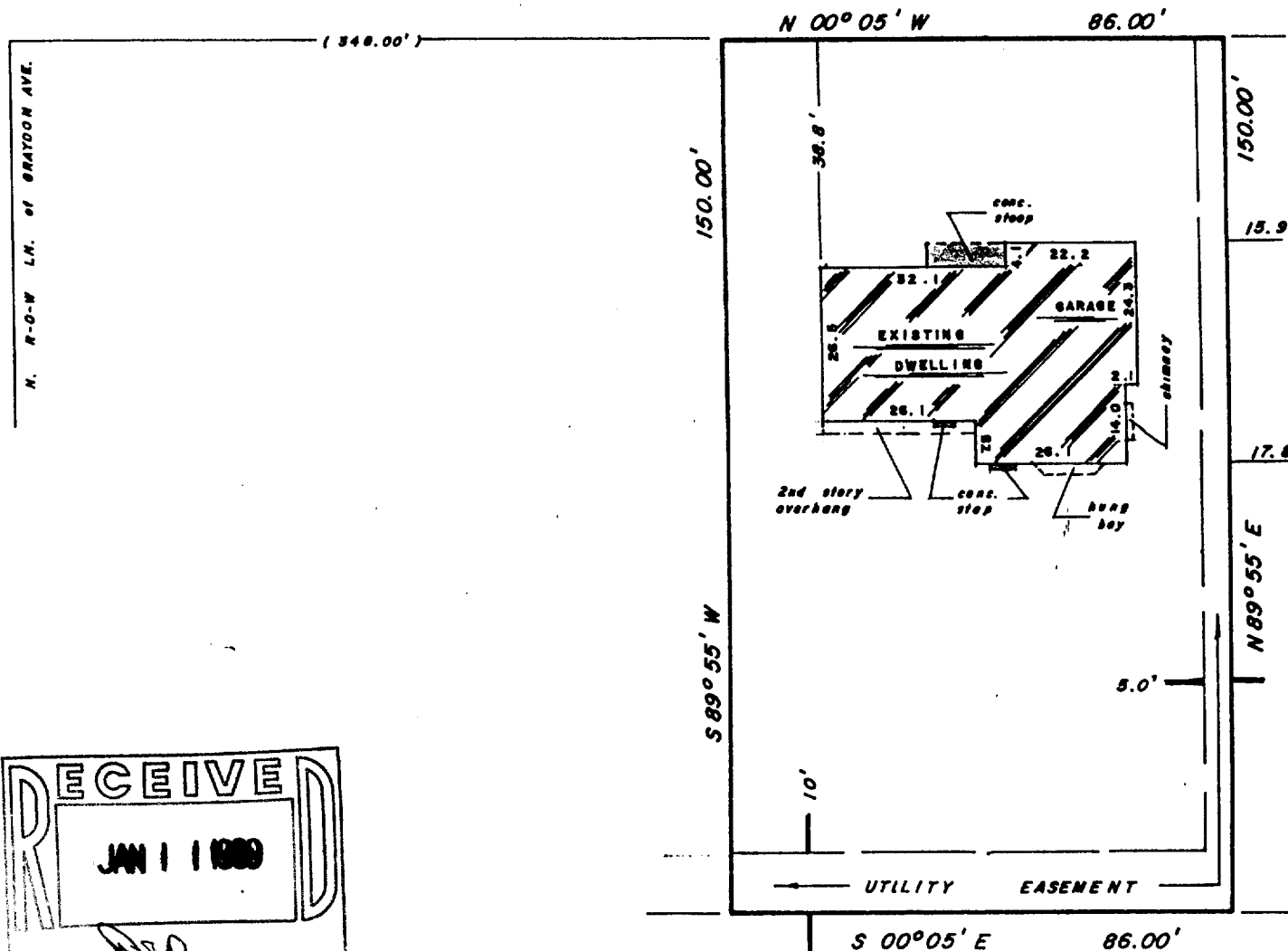

SCALE

1" = 30'

Surveyed for: LOMAS & NETTLETON CO.

"I hereby certify that I have surveyed the above described property and that the above map is a true representation thereof and shows the size and location of the property, its exterior boundaries, the location of all visible structures and dimensions of all principal buildings thereon, boundary fences, apparent easements, roadways and encroachments, if any.

"This survey is made for the use of the present owners of the property, and also those who purchase, mortgage, or guarantee the title thereto within one year from date hereof."

MONUMENTATION BY WRITTEN AGREEMENT WITH THE ABOVE NAMED CLIENT (HAS ~~NOT~~ BEEN WAIVED IN ACCORDANCE WITH A-E 5.01 (1) (b) OF THE WISCONSIN ADMINISTRATIVE CODE



"THIS IS NOT AN ORIGINAL SURVEY UNLESS THIS SEAL IS RED."

Frederick W. Shibilski
WISCONSIN REGISTERED LAND SURVEYOR

JAN. 14, 1987
DATE

bjw / drs
FIELD WORK BY

dll / bjw
DRAWN BY

15347
JOB NUMBER